

RUSH
WITT &
WILSON



RUSH
WITT &

**Top Floor Maisonette, 102 Queens Road, Hastings, TN34 1RL
Offers In Excess Of £160,000**

Rush Witt & Wilson are pleased to welcome to the market this **TWO BEDROOM MAISONETTE** located in the central regions of Hastings Town. If you are seeking an apartment well positioned for access to local shops, train stations and shops then this is worth of your consideration. Offered to the market with **NO ONWARD CHAIN** and a new lease upon completion, this property boasts access via its own private entrance. On the entrance level you have the **BAY FRONTED** living room located to the frontal aspect with the kitchen/breakfast room located to the rear. The main bathroom is considered a good size and completes the layout of the entrance level. Making your way up the internal stairs you will reach the two bedrooms with the main bedroom towards the front of the property spanning the whole width of the property. As you come up the stairs you will notice a door that takes you out to an area of outside space above the bathroom, this space is ideal to catch the morning sunshine. The property appeals to any purchaser looking to add their own style too and would be an ideal consideration for a first purchase. We look forward to showing you around this two storey apartment on Queens Road.





RUSH
WITT &
WILSON



RUSH
WITT &
WILSON



RUSH
WITT &
WILSON



RUSH
WITT &
WILSON





Floor 0

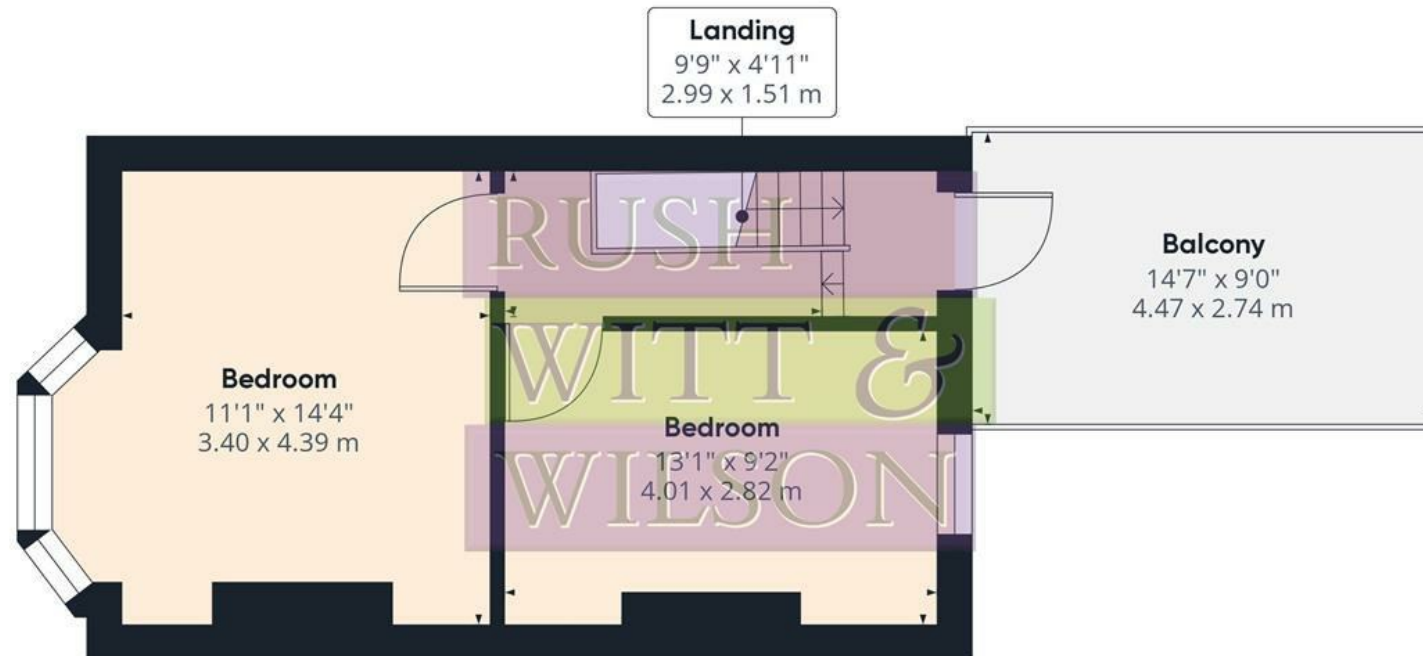

Floor 1

Approximate total area⁽¹⁾

778.56 ft²

72.33 m²

Reduced headroom

15.08 ft²

1.4 m²

(1) Excluding balconies and terraces

Reduced headroom
(below 1.5m/4.92ft)

While every attempt has been made to ensure accuracy, all measurements are approximate, not to scale. This floor plan is for illustrative purposes only.

GIRAFFE 360

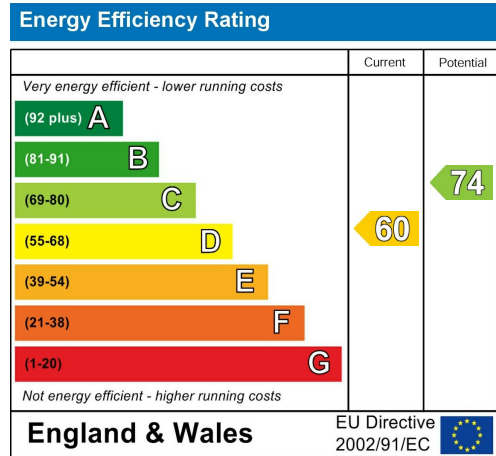
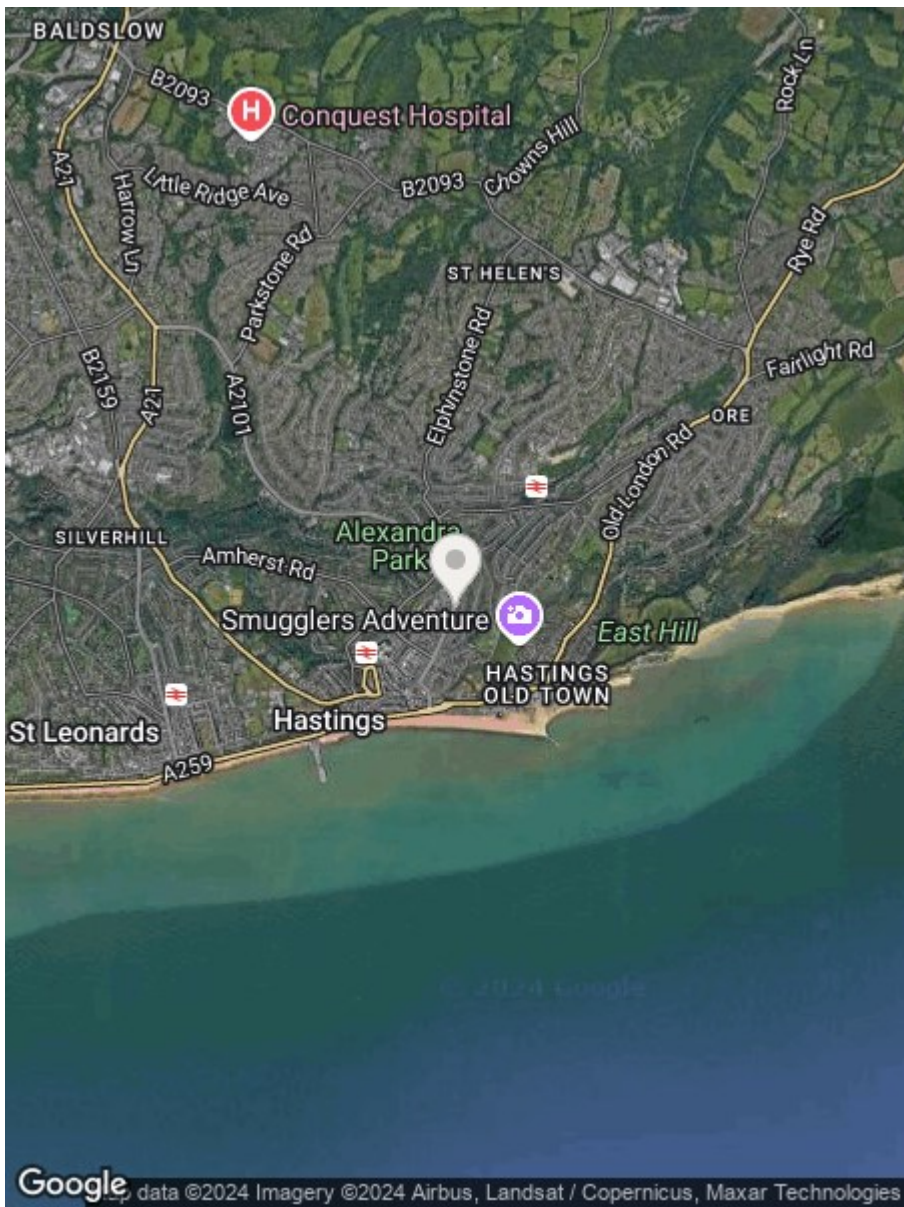

**RUSH
WITT &
WILSON**

**Residential Estate Agents
Lettings & Property Management**



**Rother House Havelock Road
Hastings
East Sussex
TN34 1BP
Tel: 01424 442443
hastings@rushwittwilson.co.uk
www.rushwittwilson.co.uk**